

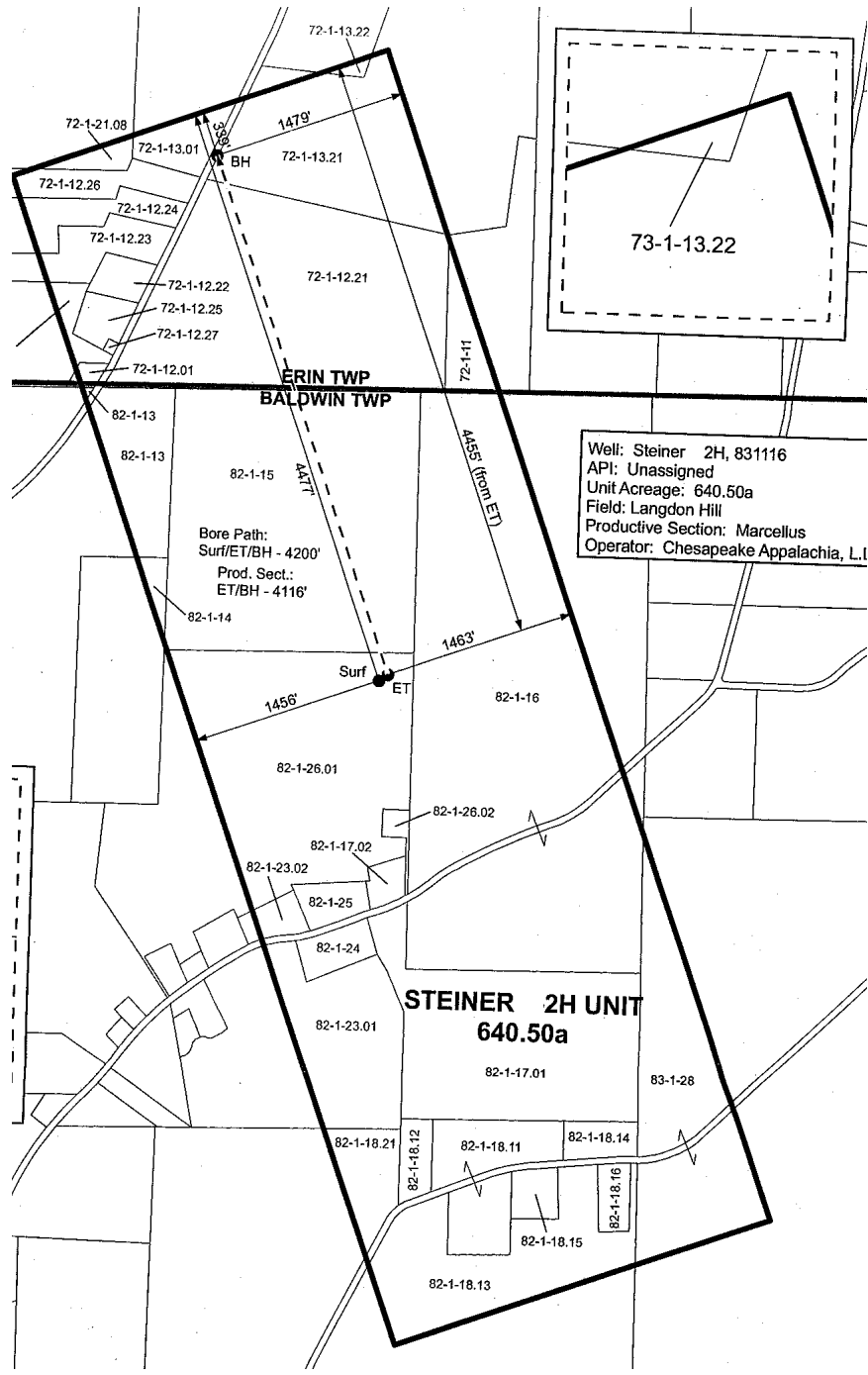

Providing a voice for landholders who leased mineral rights before Marcellus shale gas exploitation was known to threaten our land, air, water and communities.

fleased.org * 607-539-7133 * fleasedny@gmail.com



Well: Steiner 2H, 831116
 API: Unassigned
 Unit Acreage: 640.50a
 Field: Langdon Hill
 Productive Section: Marcellus
 Operator: Chesapeake Appalachia, L.L

ERIN TWP
 BALDWIN TWP

**STEINER 2H UNIT
 640.50a**

Bore Path:
 Surf/ET/BH - 4200'
 Prod. Sect.:
 ET/BH - 4116'

ART

4455 (R) (ET)

If you signed a lease:

- Will anyone buy your property?
- Can you get a mortgage? A home equity loan?
- What is your liability?
- Can you get insurance?
- Can you build on/alter the surface of your land?
- How long will the lease persist?

Leases vary by state, company and negotiation

- What is leased? All minerals, oil and gas, specific formation?
- Non-disclosure
- Renewal and “held by production”
- Was there fraud?